

Test Stand

SV Series [SV-1 / SV-2]

Handy-Type Manual Test Stand



SV-1

SV-2-S

(Force gauges are sold separately)

[Applications]

- Measuring of bonding strength of the lead wires for IC parts
- Measuring of contact press for touch panel or keyboard

[Features]

- Two types available: Handle Wheel type (SV-2) is for easy and speedy operation. Lever type (SV-1) is for speedy pressure application.
- The test stand with distance meter (SV-2) is to measure force and move distance with the length resolution 0.01 mm.
- It is easy to transport due the compact bench model.

[SV-1 /SV-2 Specifications]

Model	SV-1	SV-2
Capacity	500N	500N
Usage	Compression	Compression/Tension
Stroke	60mm	
Operation method	Lever operation	Handle operation
Stroke	60mm (angle 110°)	2mm/one complete turn of hand wheel
Function	Mechanical stopper	
Dimension	See next page	
Weight	Approx. 9kg	Approx. 8kg
Attachable gauge	Digital force gauge : Z series, DPS series Mechanical force gauge: PS series, FB series	

[Option]

Length meter(-S)

Resolution	0.01mm
------------	--------

This option is available only for SV-2.

Long stroke(-L600)

Extend	350mm longer than standard
--------	----------------------------

[Dimension]

SV-1

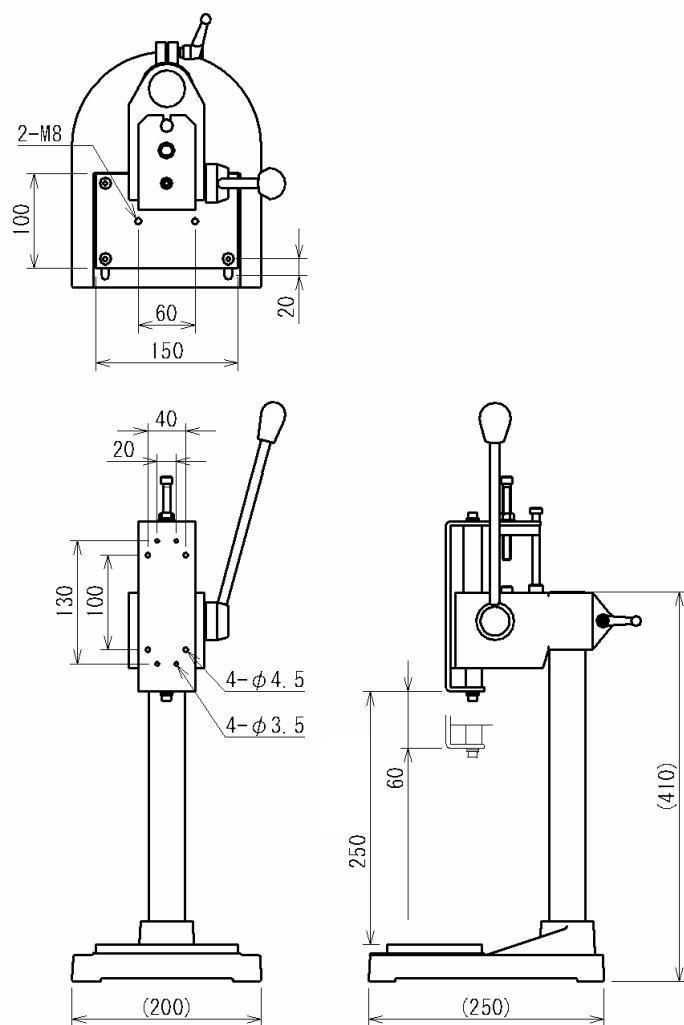

SV-2

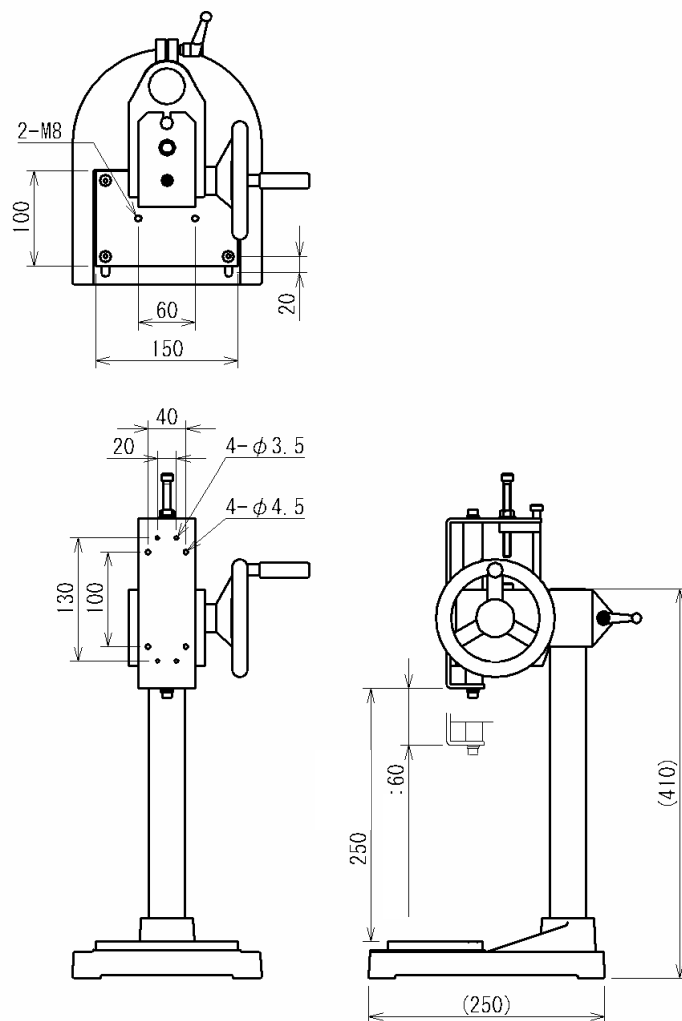

[Note]

*Force gauge (sold separately) is required for actual measuring. Please order Imada products.

*Various optional attachments are available for different types of measurement.

*All information is subject to change without prior notice.